

REVISION HISTORY				
REV	DATE	DESCRIPTION	ECO	BY
A	9/23/16	INITIAL RELEASE	15560	KY

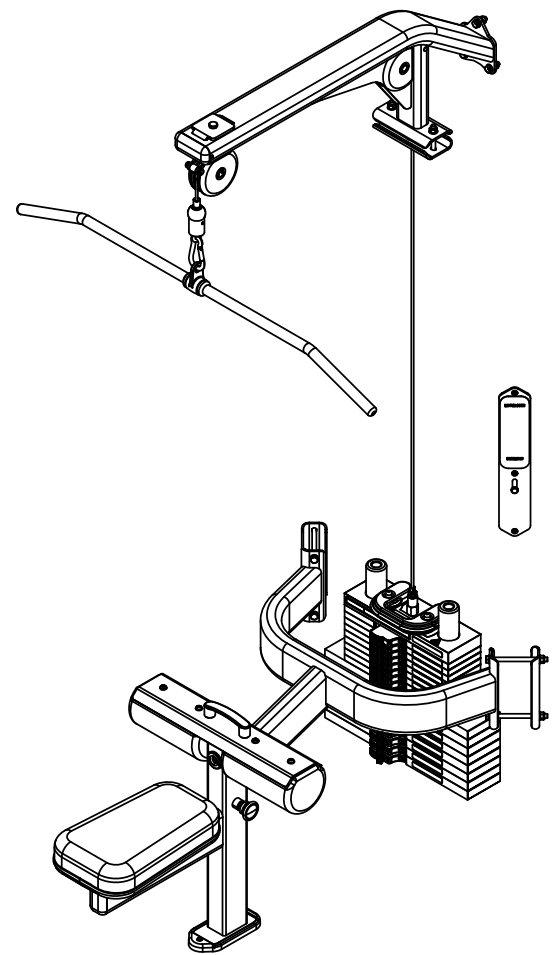
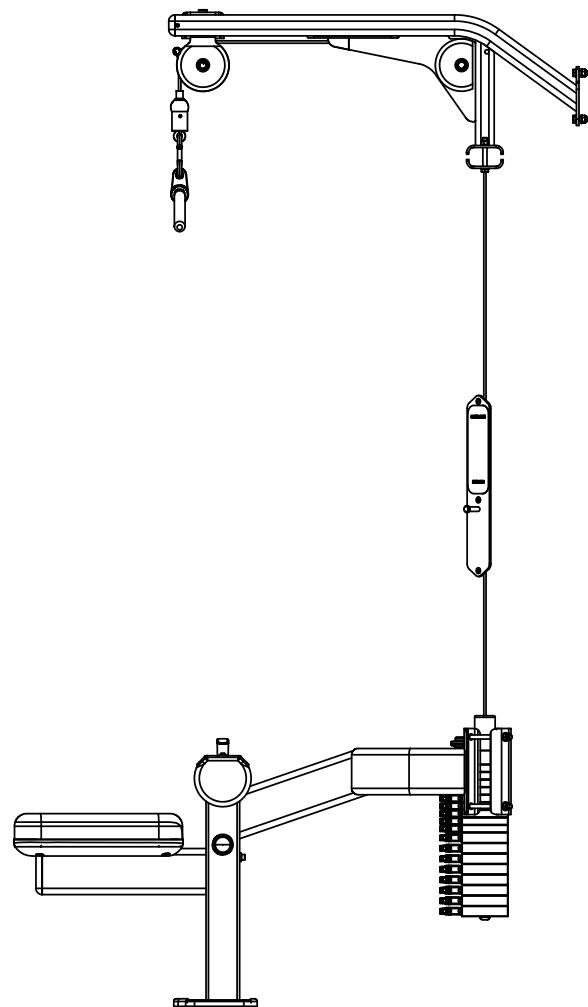
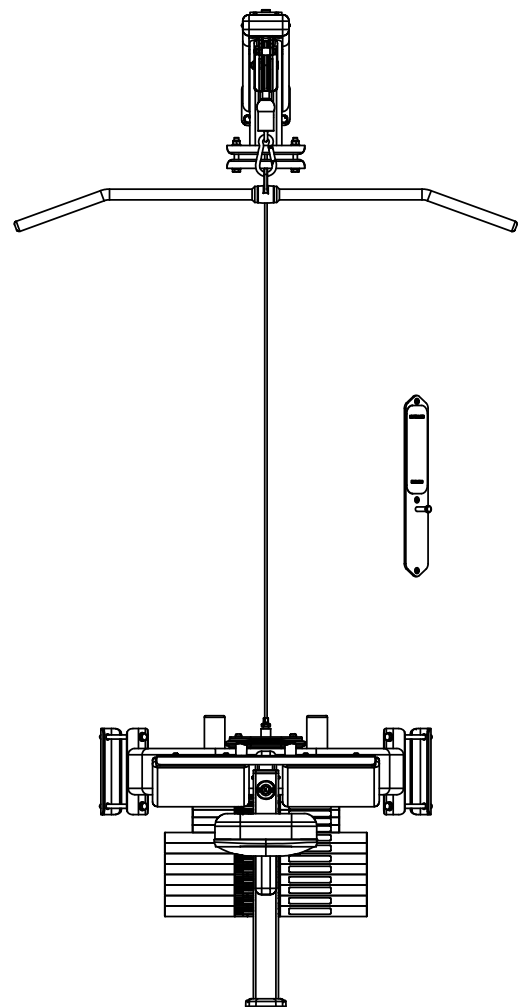
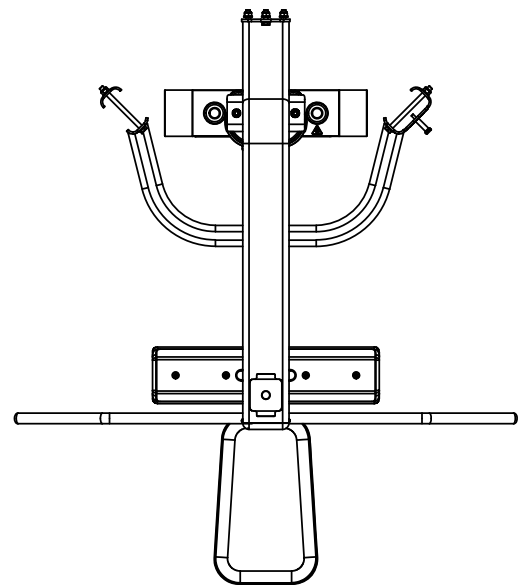

**DOCUMENT STATUS:**

NOTICE OF PROPRIETARY INFORMATION  
THIS DOCUMENT SHALL NOT BE REPRODUCED NOR SHALL THE INFORMATION CONTAINED HEREIN BE USED BY OR DISCLOSED TO OTHER EXCEPT AS EXPRESSLY AUTHORIZED BY CORE HEALTH & FITNESS, LLC.

CLASS OF WORK	UNLESS OTHERWISE SPECIFIED DIMS ARE IN mm. TOLERANCES FOR MEASURE OF LENGTH ARE:							ANGLES = ±2°		
	0.5 to 3	> 3 to 6	> 6 to 30	> 30 to 120	> 120 to 400	> 400 to 1000	> 1000 to 2000	> 2000		
FINE	±0.05	±0.05	±0.1	±0.15	±0.2	±0.3	±0.5	----		
MEDIUM	±0.1	±0.1	±0.2	±0.3	±0.5	±0.8	±1.2	±2		
COARSE	±0.2	±0.3	±0.5	±0.8	±1.2	±2	±3	±4		
VERY COARSE	----	±0.5	±1	±1.5	±2.5	±4	±6	±8		

<b>MATERIAL</b> SEE BOM	<b>THIRD ANGLE PROJECTION</b> 	
<b>FINISH</b> SEE BOM	DRAWN	DATE
VENDOR: <b>HDT</b>	INITIAL KY	9/23/16
P/N:	U.O.M.	MM

<b>CORE HEALTH &amp; FITNESS, LLC</b> 4400 NE 77th Ave., Suite 300 Vancouver, WA 98662		
CORE PART NO	REV	
731-7724-XXXX	A	
TITLE NAU, LAT PULL STATION		
SCALE: 1:18	SHEET 1 OF 3	SHEET SIZE: B

9		8		7		6		5		4		3		2		1	
		ITEM NO.	PART NUMBER	DESCRIPTION		QTY.				ITEM NO.	PART NUMBER	DESCRIPTION		QTY.			
J		1	27-0277	ASSEMBLY, MOLDED HANDLE, RED		1		41	731-3652	PLASTIC,SEAT,NARROW TUBE,FR		1		J			
		2	110-3783	SCREW,M10x1.5,140MM,HHC,HE,AS,ZP,GR12.9		4		42	731-3653-XX	WELD,THIGH PAD SLIDER,LP		1		I			
		3	110-3814	SCREW,M10x1.5,30MM,HHC,HE,AS,12.9,ZC		3		43	731-4176	BAR, LAT, FLB		1					
		4	110-3821	SCREW,M10x1.5,60mm,HHC,HE,AS,12.9,ZC		1		44	731-4187	ASSY,CABLE,LP		1					
I		5	110-3880	SCREW,M8x1.25,45mm,HHC,HE,AS,ZC,GR12.9		1		45	731-4420	ASSY,WELD,PULLEY,PIVOT,MS		1					
		6	110-3883	SCREW,M10x1.5,55MM,HHC,HE,AS,12.9,ZC		1		46	731-4428	SCREW,M8 X 1.25,120MM,SHC,HK,NP		1					
		7	731-0034	WASHER,M8,34MM OD,1.5MM THK		2		47	731-4430	RACE,INNER PIVOT,MS		1					
		8	731-0127	RACE,WEAR SLEEVE,CABLE		1		48	731-4585	CAP,PULLEY,MS, INNER BOOM		2					
		9	731-0130	Bearing, 6202ZZ, Ø15xØ35x11mm		2		49	731-4586	CAP,PULLEY,MS, OUTER BOOM		2					
H		10	731-0169	SCREW, M8X1.25,20MM, BHC, HK		2		50	731-5330	SCREW,M8x1.25,25,SHC,HK,AS,12.9,ZP,FT		1					
		11	731-0173-00XX	ASSY,KNEE PAD,STD		2		51	731-5516	SCREW,M10x1.5,75mm,HHC,HE,AS,12.9,ZC		2		H			
		12	731-0209	CAP, END, 110 X 50		2		52	731-7351	PLACARD,LAT PULL, NAU		1					
		13	731-0225	SCREW,M3.5 X 9.5,SELF TAPPING		6		53	731-7525-XX	WELD,LAT PULL,UPPER		1					
		14	731-0287	NUT,M8x1.25,NYLOCK		1											
G		15	731-0355	WASHER,PLAIN,M8,NARROW		8											
		16	731-0359	SCREW,M8 X 1.25,25mm,BHC,HK		4											
		17	731-0363	NUT,M10X1.5,NYLOC		11											
		18	731-0365	NUT,M8 X 1.25,NYLOC JAM		1											
		19	731-0367	WASHER,PLAIN,M10		22											
F		20	731-0379	SCREW,M8 X1.25,20mm,SHC,HK		4											
		21	731-0635-00XX	ASSY, SEAT BOTTOM, ROW		1											
		22	731-0637	RING,BEAUTY,ADJ,PAD		1											
		23	731-0638	SUPPORT,TUBE,ADJ,CHEST		1											
E		24	731-0652	ASSY,PULL PIN,ADJ,RED		1											
		25	731-0731	ASSY,PULLEY,Ø120MM,CABLE		2											
		26	731-1194	SCREW,M6 x 1.0,16mm,FHM,HK		3											
		27	731-1939	RING,RETAINING,ID,35MM		2											
		28	731-1943	WASHER,M15,OD 25MM,3MM THK		2											
D		29	731-2016	CLIP,CARABINEER,3/8 IN.,CLP		1											
		30	731-2079	SCREW,M4 X .7,8MM,SHC,HK,NP		2											
		31	731-2080	BUMPER,ADJ,HYPER		1											
		32	731-2647	FOOT, LONG, LEVERAGE		1											
		33	731-2850	STICKER,ADJ,1-8,LEV		1											
C		34	731-3164-XX	WELD,PLACARD,MS		1											
		35	731-3169	PLATE,ADD ON WEIGHT		1											
		36	731-3178	BRACKET, CONNECTOR, 76.2MM		1											
		37	731-3209	ASSY,SWIVEL,HANDLE,MS		1											
B		38	731-3221	BRKT,MOUNT,DOUBLER,MS		2											
		39	731-3641	ASSY,WGT STK,130KG,MS		1											
		40	731-3648-XX	WELD,LAT PULL,LOWER		1											

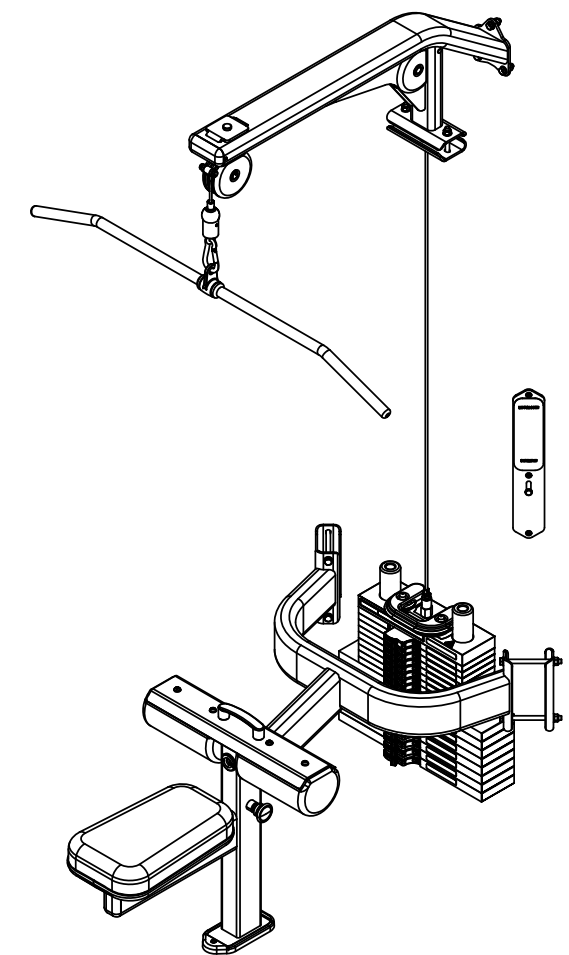

**CORE HEALTH & FITNESS, LLC**  
4400 NE 77th Ave., Suite 300  
Vancouver, WA 98662

CORE PART NO: **731-7724-XXXX** REV: **A**

TITLE: **NAU,LAT PULL STATION**

SCALE: 1:18 SHEET 2 OF 3 SHEET SIZE: B

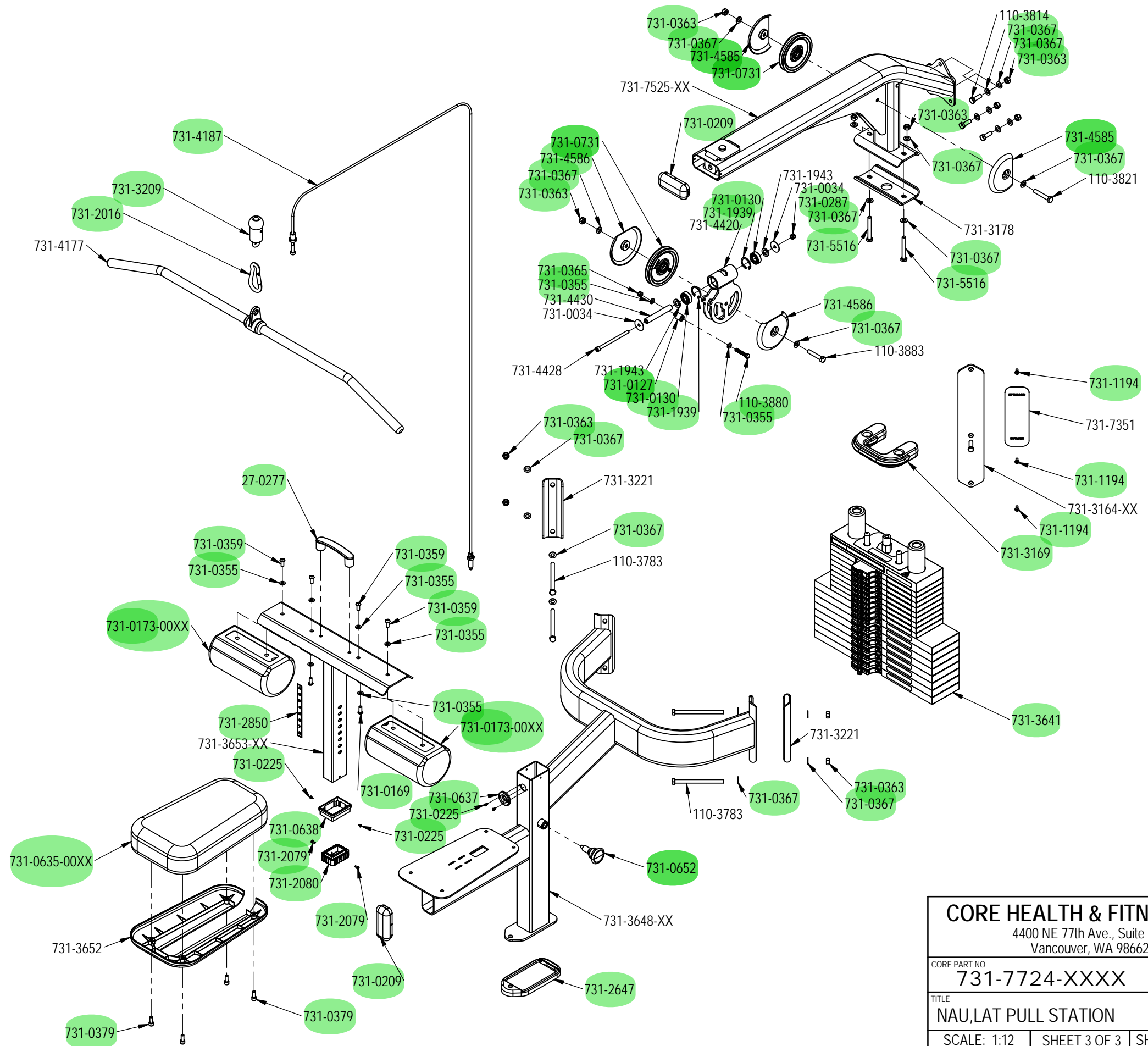

<b>CORE HEALTH &amp; FITNESS, LLC</b>		
4400 NE 77th Ave., Suite 300 Vancouver, WA 98662		
CORE PART NO	731-7724-XXXX	REV A
TITLE NAU,LAT PULL STATION		
SCALE: 1:12	SHEET 3 OF 3	SHEET SIZE: B